

Industrial 2-port 10/100/1000Base-T + 2-port 100/1000Base-X SFP Ethernet Switch

Features

- ▶ 2-port 10/100/1000BASE-T RJ45 with auto MDI / MDI-X function
- ▶ 2 SFP Port, 100Base-FX or 1000Base-X dual mode (auto detection)
- ▶ Supports Link Fault Pass Through
- ▶ Supports Full/Half-duplex, Auto-negotiation
- ▶ 9K Bytes Jumbo Frame
- ▶ 12~48VDC Terminal Block Power Input
- ▶ Supports DIN-Rail & Wall-mount installation
- ▶ Environmentally hardened -40°C to 75°C (-40°F to 167°F) operating temperature



Overview

LNK-IMC202G-SFP Series is a DIN rail type Ethernet Switch that supports external SFP Modules and meets EN55022 standard. It is a hardened grade product whose operating temperature range is -40° C to +75° C. LNK-IMC202G-SFP supports 10/100/1000Base-T and 100/1000Base-X SFP Port. The Ethernet port supports both half-duplex and full-duplex mode. Users can use different type of SFP modules (single-mode/multi-mode fiber, 1/2 core) as needed.

Application

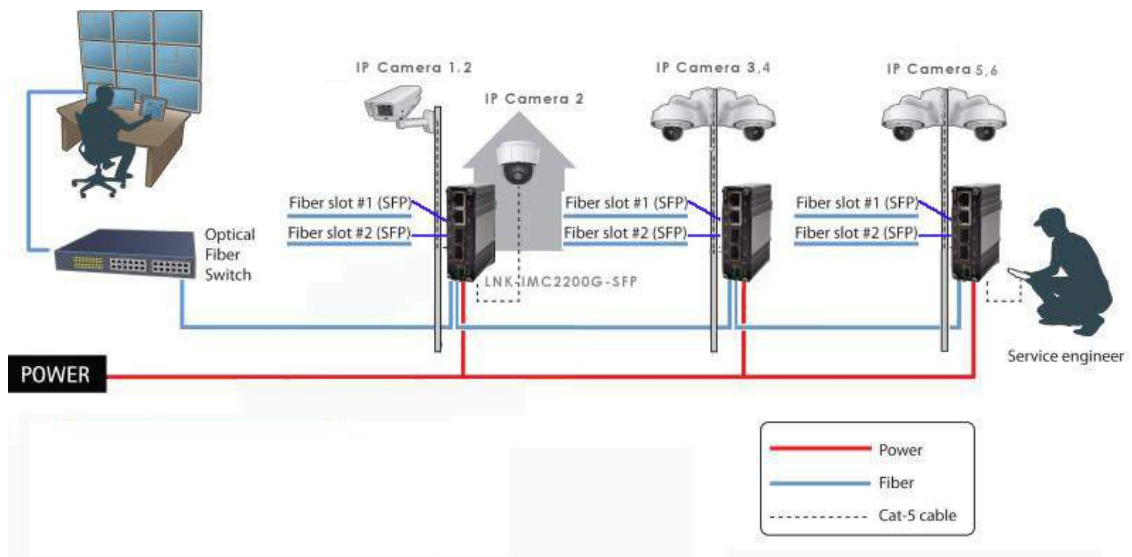

Technical Indexes

Ethernet	
Standards:	IEEE802.3 10Base-T
	IEEE802.3u 100Base-TX/FX
	IEEE802.3ab 1000Base-T
	IEEE802.3z 1000Base-X
Processing Type:	Store-and-Forward
Forward Filter Rate:	14,880pps (10Mbps)
	148,800pps (100Mbps)
	1,488,000pps (1000Mbps)
Packet Buffer Memory:	1 Mbit
Max Packet Length:	9K Bytes
Address Table Size	2K MAC Addresses
Interface	
Connector:	2 x RJ45
Optical Port:	2 x SFP 1000Base-X or 100Base-FX (auto detection)
Electrical and Mechanical	
Input Power:	12~48VDC, 2-pin terminal block
Power Consumption:	5W Max.
LED Indicators:	
PWR:	Power Status
RJ45:	LINK/Activity
SFP:	LINK
Dimensions (WxDxH):	95 x 70 x 30 mm
Weight:	0.25Kg
Casing:	Aluminum Case
Mounting Options:	DIN-Rail / Wall-mount
Environmental	
Operating Temperature:	-40°C to 75°C (-40°F to 167°F)
Storage Temperature:	-40°C to 85°C (-40°F to 185°F)
Relative Humidity:	5% to 95% non-condensing
MTBF	> 200,000 hrs
Regulatory Approvals	
ISO9001, CE, FCC, RoHS	
EMI:	
EN55022:2010+AC: 2011, Class A	
EN 61000-3-2: 2006+A1: 2009+A2: 2009	
EN 61000-3-3: 2013	
EN55024: 2010	

EMS:

IEC 61000-4-2: 2008 (ESD)

IEC 61000-4-3: 2010 (RS)

IEC 61000-4-4: 2012 (EFT)

IEC 61000-4-5: 2014 (Surge)

IEC 61000-4-6: 2013 (CS)

IEC 61000-4-8: 2009 (PFMF)

Ordering Information

Model	Description
LNK-IMC202G-SFP	Hardened 2-Port 10/100/1000BASE-TX to 2x100/1000BASE-X SFP Ethernet Switch
SFP Options	▶ SFP option. Please select your SFP on our SFP Options Page (Industrial SFP).
	▶ SFP module is to be purchased separately.
Mounting Options	▶ Default DIN-Rail Bracket installed, Wall Mount Bracket is included.
Power Options	▶ 24W/1A 24VDC Power Supply. Open Wire for Terminal Block
	▶ Power Supply is to be purchased separately.